

1. INSTALL THE CONTROLLER TOGGLES AND BATTERIES

Slide open the joystick box cover and the battery cover on the bottom of the Controller. Insert the joysticks into the holes in the Controller toggles and install 4 AAA batteries as shown below.

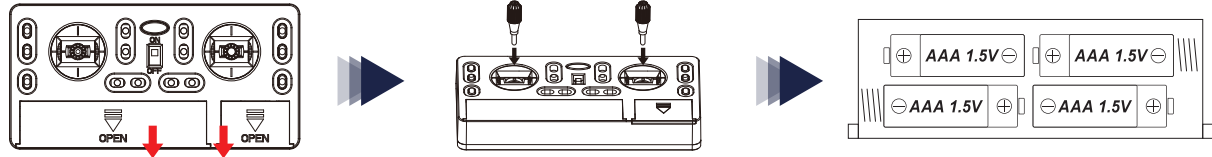

2. POSITION the DRONE'S PROPELLERS

Carefully pull out all four of the Drone's propellers. Then pull the body of the propeller motor away from the drone about 1/8th of an inch. Turn to lock the propellers in an upright position.

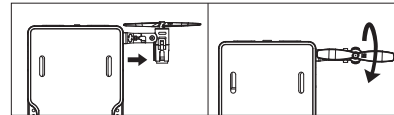

3. CHOOSE A SAFE TAKE-OFF LOCATION

Lay the Drone down on a flat surface with adequate space around it. Fly outside only on a sunny day with little or no wind. Make sure no people or pets are in range.

4. TURN ON THE DRONE & THEN THE CONTROLLER

Turn on the Drone by sliding the switch in the center of its back edge to the "ON" position—the 4 LED lights will blink. Turn on the Controller by sliding the switch between the two toggles to the "ON" position—its red power light will blink. Wait 7 seconds for the internal digital gyro to stabilize.

5. PAIR the CONTROLLER and DRONE and START the PROPELLER MOTORS

Push the throttle stick on the Controller (the left stick) up to the top (12 o'clock position) and then pull it down to the bottom (6 o'clock). Pairing is confirmed when the Controller power light and the Drone's LEDs stop blinking. Push the Start/Stop button or the Auto-Takeoff button, both at the bottom, right-hand corner to start the propeller motors.

6. TAKE OFF!

Push the throttle stick (on the left) upward until the Drone reaches the desired altitude. Release the throttle and your Drone will maintain its altitude. Use your right directional stick to maneuver your drone.

7. REFER TO THE DIAGRAMS BELOW to CONTROL YOUR POCKET DRONE IN FLIGHT.

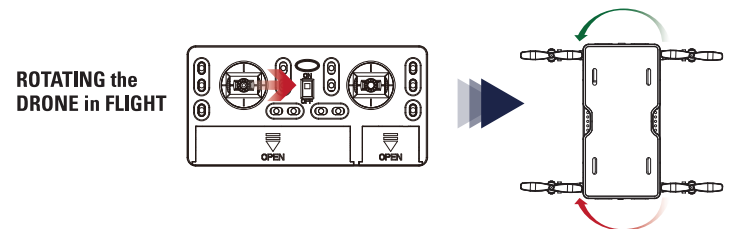
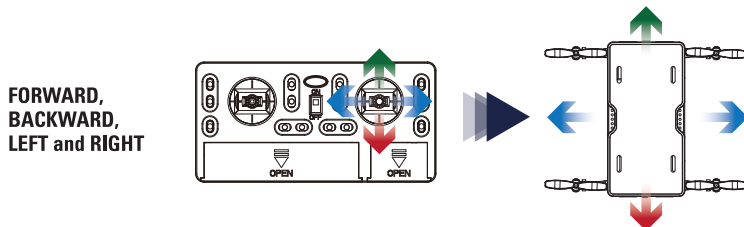

8. TO LAND, PULL the THROTTLE STICK (LEFT STICK) DOWNWARD or PRESS AUTO LAND.